

Unequal Flange Rack

Homaco Unequal Flange Racks provide the equipment support structure necessary for a reliable network. The welded 11-gauge steel rack is designed to withstand the demands of central office applications, including voice, data, and video.

Mounting holes are drilled and tapped on both the front and rear flanges of the frame to accept a variety of equipment and accessories. Front guard box included.

Features:

- Meets all NEBS requirements
- Easy to anchor and to install equipment
- 1/2" junctioning holes secure multiple-rack line-ups
- 12-24 assembly mounting screws and cable tie holders included

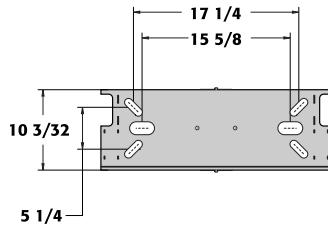

23"W footprint

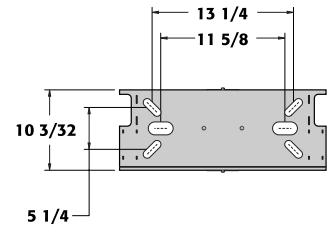

19"W footprint

Catalog No.	Dimensions	Duct	Hole Pattern	RMS*	Ship Weight
Channel Top Style					
19-84-UPC	84.00"H x 19.00"W x 10.09"D	Open	1.75"	43	78 lbs
23-84-UCA	84.00"H x 23.00"W x 10.09"D	Closed	1.00"	74	80 lbs
23-84-UCC	84.00"H x 23.00"W x 10.09"D	Closed	1.75"	43	80 lbs
23-84-UPC	84.00"H x 23.00"W x 10.09"D	Open	1.75"	43	80 lbs
Top Angle Style					
19-84-UPCA	84.00"H x 19.00"W x 10.09"D	Open	1.75"	43	78 lbs
23-84-UCAA	84.00"H x 23.00"W x 10.09"D	Closed	1.00"	74	80 lbs
23-84-UCCA	84.00"H x 23.00"W x 10.09"D	Closed	1.75"	43	80 lbs
23-84-UPCA	84.00"H x 23.00"W x 10.09"D	Open	1.75"	43	80 lbs

Dove gray finish. *Rack mount spaces.

Solid Runway

Solid Runway junctions to auxiliary framing and assures appropriate cable support. Runway is available for various applications and is used in conjunction with hardware kits to accommodate a variety of configurations. Accessories provide additional cable capacity and allow smooth cable transitions.

Features:

- Channel cross slats are welded between stringers
- Cross slats feature rolled edges for cable protection
- Constructed of heavy-duty 3/8" steel bar
- Rust-resistant dove gray finish
- Meets NEBs standards
- UL listed

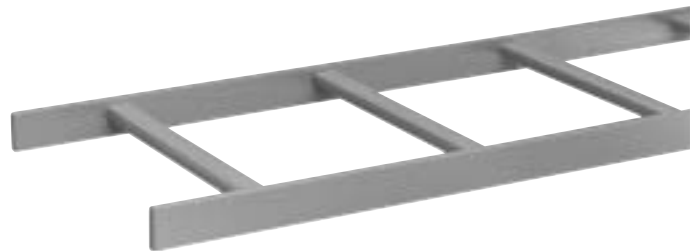

Catalog No.	Dimensions	Load Rating	Ship Weight
2-E1-1-5WS	1.50"H x 5.00"W x 9' 8.50"L	115 lbs	42 lbs
2-E1-1-10WS	1.50"H x 10.00"W x 9' 8.50"L	115 lbs	47 lbs
2-E1-1-12WS	1.50"H x 12.00"W x 9' 8.50"L	115 lbs	49 lbs
2-E1-1-18WS	2.00"H x 18.00"W x 9' 8.50"L	115 lbs	67 lbs
2-E1-1-20WS	2.00"H x 20.00"W x 9' 8.50"L	115 lbs	69 lbs
2-E1-1-25W*	2.00"H x 25.00"W x 9' 8.50"L	115 lbs	74 lbs
2-E1-1-30W*	2.00"H x 30.00"W x 9' 8.50"L	115 lbs	79 lbs

Dove gray finish. *Reinforced. Load rating 115 lbs. per foot.